

RADFLEX 125 DOUBLE LAMINATE BONDED TO CONCRETE

LANDSCAPE FINISHES BY OTHERS

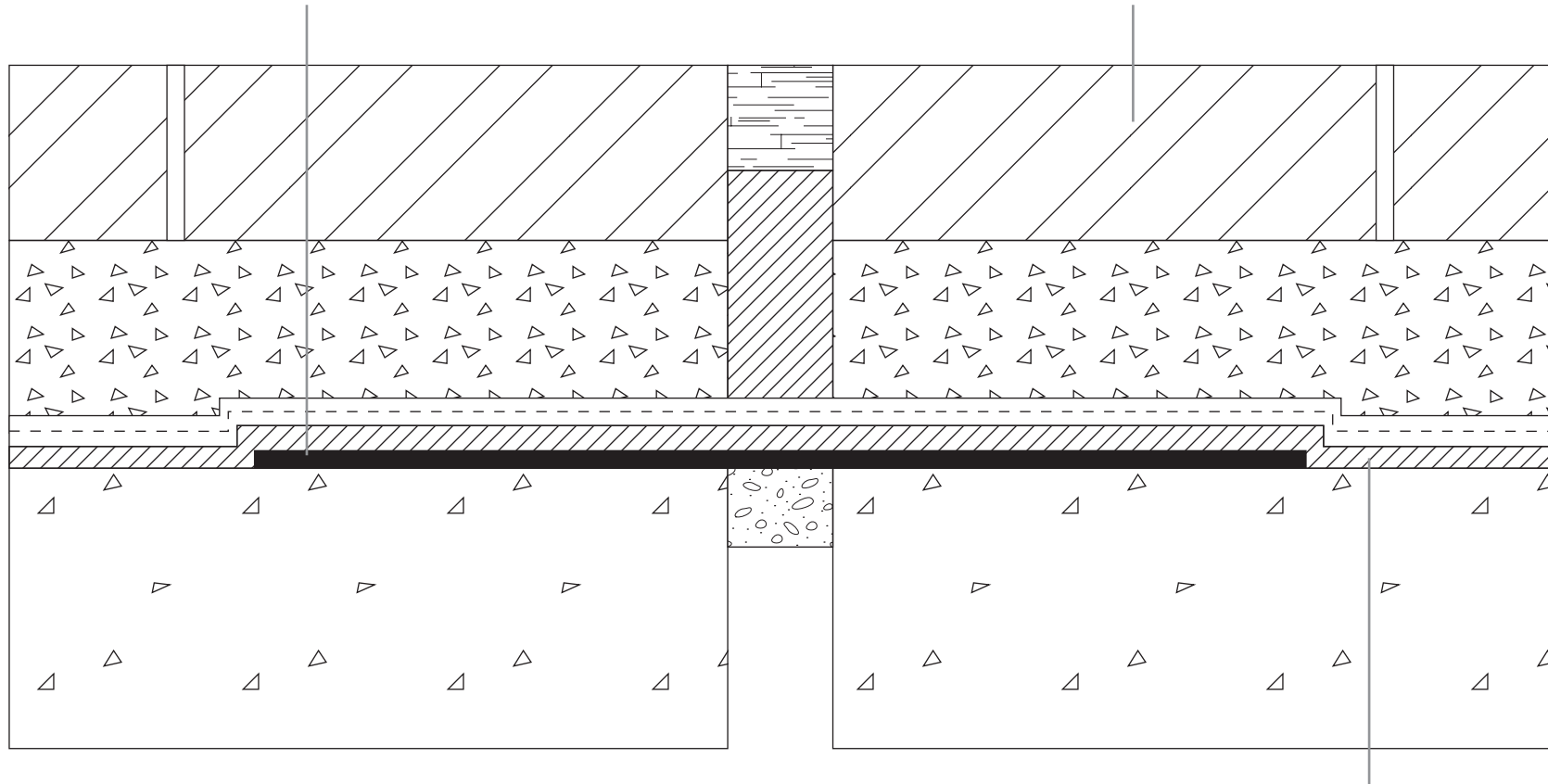

SECTION THROUGH JOINT

HOT RUBBER OR LIQUID APPLIED WATERPROOFING WITH PROTECTION SHEET (AND DRAINAGE LAYER IF REQUIRED)



Title:

**RADFLEX 125 BONDED TO CONCRETE WITH HOT RUBBER
OR LIQUID APPLIED WATERPROOFING UNDER
LANDSCAPE FINISHES**

Radflex Contract Services Limited
Unit 35 Wilks Avenue
Questor
Dartford DA1 1JS

Tel: 01322 276363
Fax: 01322 270606
Web: www.radflex.co.uk

Scale: Not to Scale

All dimensions in mm

Drawing No: 125/C2

Standard Details