

PAVOIRS ON SAND OR SCREED

ALUMINIUM JOINT PROFILE

PROTECTION BOARD OR SHEET

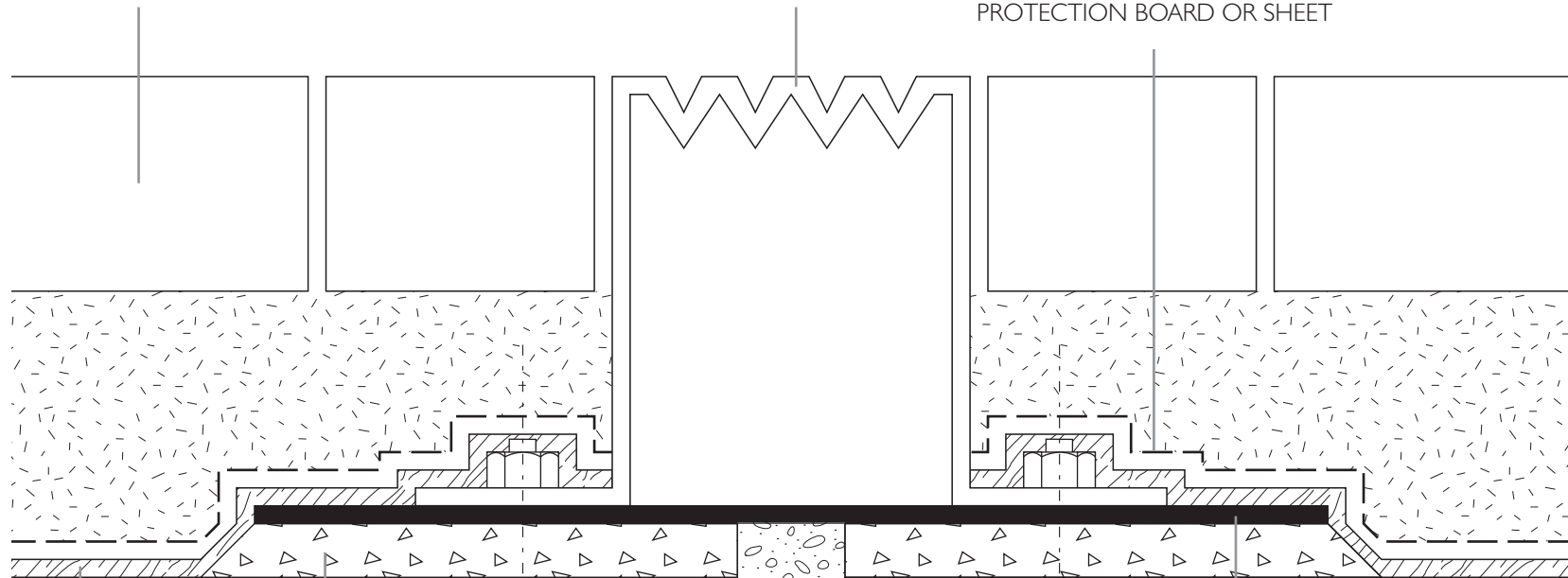

HOT RUBBER WATERPROOFING MEMBRANE

POLYMER MODIFIED MORTAR HAUNCHES
225mm WIDE x 10mm DEEP

CLOSED CELL FOAM

10mm DIA STAINLESS STEEL
CHEMICAL FIXING ANCHORS

RADFLEX 125 DOUBLE LAMINATE 450mm WIDE
BONDED TO CONCRETE WITH RADFLEX
EPOXY ADHESIVE



Title:

**RADFLEX 125 USED WITH HOT RUBBER WATERPROOFING
AND ALUMINIUM MECHANICAL MOVEMENT JOINT**

Scale: Not to Scale

All dimensions in mm

Drawing No: 125/C5

MARCH 2008

Radflex Contract Services Limited
Unit 35 Wilks Avenue
Questor
Dartford DA1 1JS

Tel: 01322 276363
Fax: 01322 270606
Web: www.radflex.co.uk